

Service
Service
Service

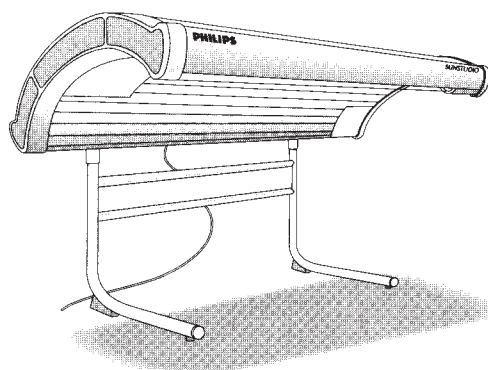

Domestic Appliances and Personal Care

Service Manual

GENERAL

The full-body tanner Sunstudio Combi HB 573/A is equipped with a 30-minute timer.

After the pre-set tanning time, the appliance automatically switches off.

To guarantee even tanning, the three outer TL's of the canopy are operated by means of 100 W ballasts and the six inner TL's are operated by means of 80 W ballasts.

It has one fan for adequate cooling of the appliance during operation.

When choosing a place for the appliance, make sure there is enough free space around the appliance to guarantee proper cooling.

TECHNICAL DATA

operating voltage	: 220-230 V~, 50 Hz
power consumption	: approx. 1185 W
ballast canopy	: 6 x 100 W
	: 6 x 80 W
starter type canopy	: 12 x S 11
lamp type canopy	: 12 x Cleo Professional 90W/S
timer	: 1 x 30 min
safety class	: double insulation
test mark	: CE
length of mains cord	: approx. 3 m
irradiation field	: approx. 200x85 cm
dimensions	: approx. 216x111x111 cm
	: (L x W x H)
height adjustment	: approx. 72.5 - 92.5 cm

MSH Coding 8843 573 00000



DISASSEMBLY

Remove four ornamental props (6) from the end covers (7 + 14) on either side of the canopy with a screwdriver and undo the screws.

Detach the end covers from the canopy.

Now the starters (9) of the TL's and the timer (13) can be removed.

Pull the two side covers (7A/fig. 1) off the lower part of the aluminium profile.

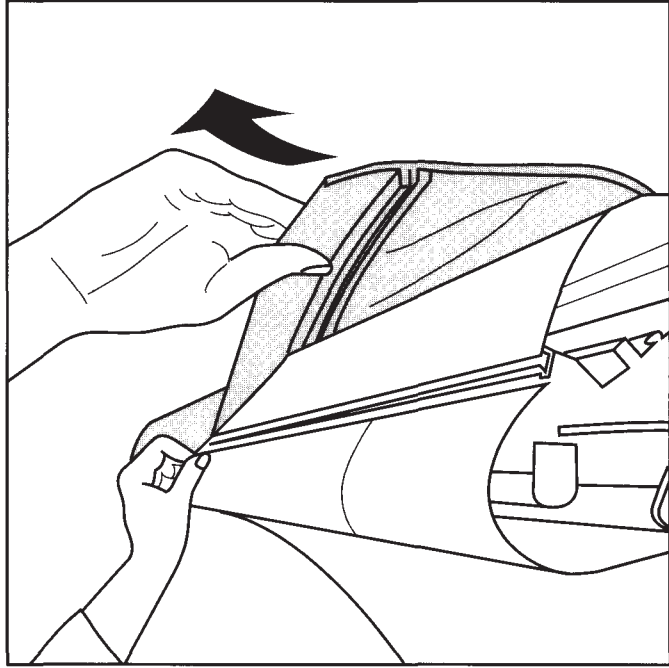

fig. 1

Pull the plastic locking pins (18A) out (fig. 2) and detach the acrylic sheet (19) from the aluminium profile.

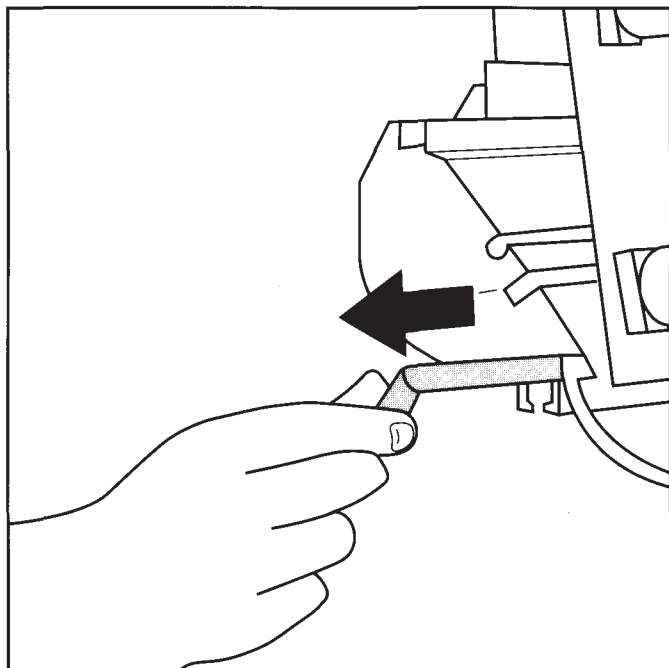

fig. 2

Now the TL's can be removed.

You need a second person to remove the acrylic sheet.

To remove the top cover (1), use a screwdriver to lever the plastic rivets (12) out of the cover.

Be careful not to damage the cover.

Pull the top cover out of the grooves of the side covers (7A) and then swing it aside towards the stand.

Support the cover after you have swung it aside!

Now all the other components can be disassembled.

To remove the fan, you first have to detach two ballasts.

Removal of complete canopy

The entire canopy can be removed from the hinged parts by undoing the carriage bolts on either of these two parts.

You need a second person to do this.

Gas-pressure springs

Swing up the canopy and have a second person secure it in this position.

Undo two nuts on either side and take the gas-pressure springs (20) out of the hinged parts.

Hinged parts

The hinged parts can be completely lifted off the stand after the carriage bolts for height adjustment have been loosened on either side.

ASSEMBLY

When assembling the acrylic sheet (19), make sure that the edges are properly inserted behind the aluminium profile (fig. 3).

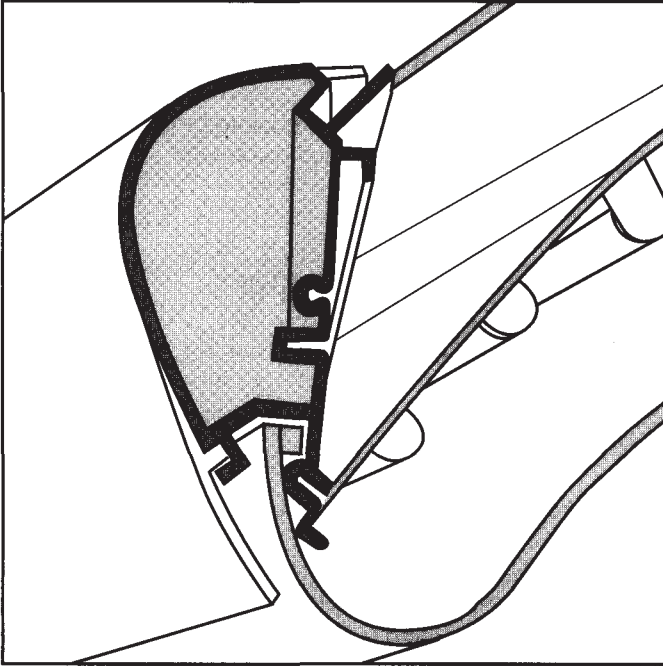

fig. 3

Then press the side covers back into the aluminium profiles (fig. 4).

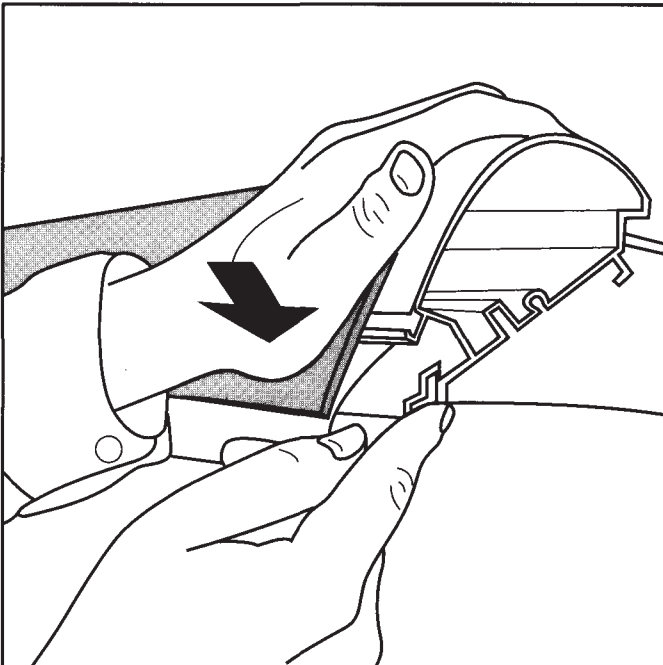

fig. 4

Assemble the four plastic locking pins. Make sure that they are completely pushed in and located on the outside of the acrylic sheet (fig. 5)

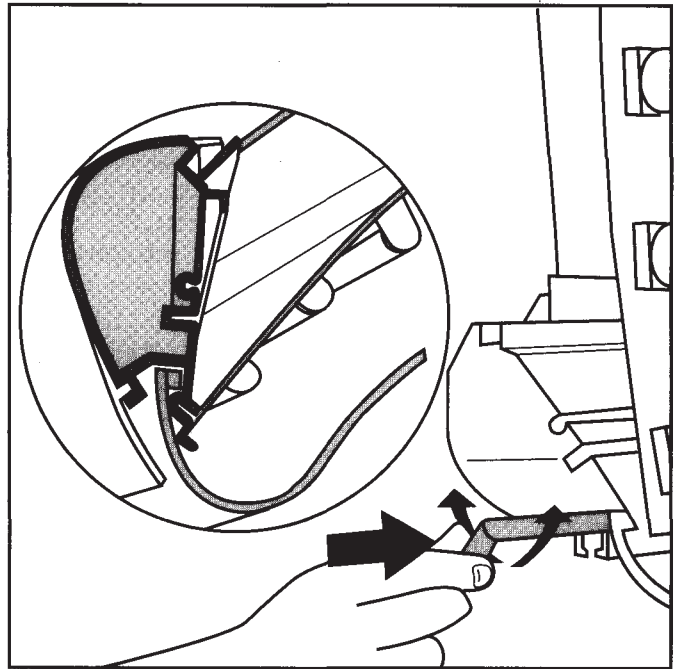

fig. 5

Slide the end covers carefully back onto the appliance (fig. 6).

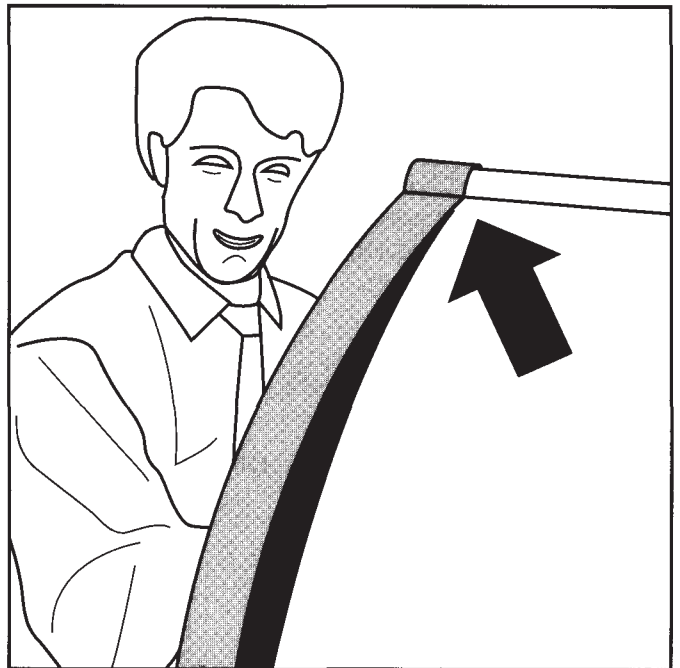

fig.6

When assembling the top cover (1), make sure that the small inlet cover (9A) for the mains cord overlaps the top cover correctly.

SERVICE TIPS

- If a fuse blows when you switch on the appliance, this is usually caused by a fuse that acts too quickly. In such a case, use of a slow 16A safety fuse is recommended on account of the high starting current.
- The fuse may also be activated as a result of a defective ballast or an overloaded circuit.
- If one or more TL's have broken down, you can track down the failure cause by interchanging parts (ballasts, starters, lamps). If these parts are OK, the wiring must be checked, especially the connections to the lamp holders.
- An unusually early blackening of the end of the TL's points to a wiring fault or a defective starter.
- The plug-in connections of the wires can be detached by means of a paper clip.
- **Always use protecting goggles when looking in the direction of burning lamps.**
- The acrylic sheet can be cleaned with a moist cloth and some washing-up liquid. Avoid the use of alcohol, alcohol-based cleaners, petrol, acetone or abrasives! These substances can cause irreparable damage to the sheets.
- Disposal of used-up or broken lamps



Used-up or broken lamps are chemical waste and must be disposed of in the appropriate manner.

IRRADIANCE

The measuring data indicated below were established with help of an LMV UV-A meter or a Hebru UV-A meter and may only be checked with this equipment, since the values measured are relative values. The measurements must be taken after approx. 5 minutes in the centre of the irradiation field and at the distance indicated. The following aspects must be checked or the following preliminary measurements must be taken:

General

- Mains voltage: 220-230V
- Room temperature approx.: 22-28°C

Checks on appliance

- Check the fan for failure-free operation as optimal irradiation is only guaranteed at the correct operating temperatures.
- Clean the reflectors, the lamps and the acrylic sheet.

With regard to the minimum irradiation indicated below, you should bear in mind that this is not an absolute value at which the lamps must be replaced. Depending on the skin type, the tanning session may also be extended so that the lamps can be used a little longer.

	distance in cm	approx. maximum irradiance of new appliances in mW/cm ²		minimum irradiance at which lamps should be exchanged in mW/cm ²	
		LMV UV-A meter	HEBRU UV-A meter	LMV UV-A meter	HEBRU UV-A meter
canopy	20	10.0	2.7	6.0	1.6

1	4822 441 11988	cover top	12	4822 532 12791	push rivet
2	4822 361 10971	fan 230V	13	4822 282 10312	timer 30mins Eaton
3	4822 146 10791	ballast 100W	14	4822 442 00895	end cover timer side
-	4822 146 10792	ballast 80W	15	4822 410 11118	timer knob
4	4822 380 10197	reflector middle	16	4822 380 10195	reflector small
4A	4822 502 14539	s.t.screw 4.8x19	17	4822 255 10375	lampholder
5	4822 380 10194	reflector side	18A	4822 535 10526	locking pin
6	4822 462 10917	ornamental prop	19	4822 466 11519	acrylic plate
7	4822 442 00893	end cover	20	4822 529 10385	gasspring 1500N
7A	4822 442 01243	side cover		4822 310 10961	mounting set
8	4822 255 10374	lamp/starterholder			
9	4822 218 11638	starter S11			
9A	4822 442 01242	cover inlet			
10	4822 321 11313	flex EU white 16A/2C			
11	4822 462 10916	ornamental cap			

HB 573/A

