

Service Information

1997-11-07

HR 8310
HR 8331

DAP156

Domestic Appliances and Personal Care

See service manual 4822 729 21837

Item 16 (4822 441 11925, upper housing).

The item has been provided with a safety valve to prevent overheating of the motor if there is not enough air displacement or if the air displacement is hampered.

The spring (A) in upper housing 4822 441 11925 is only suitable for the **/A version** (see drawing).

If this upper housing is used for the **/B version**, spring A must be replaced with spring 4822 492 11408.

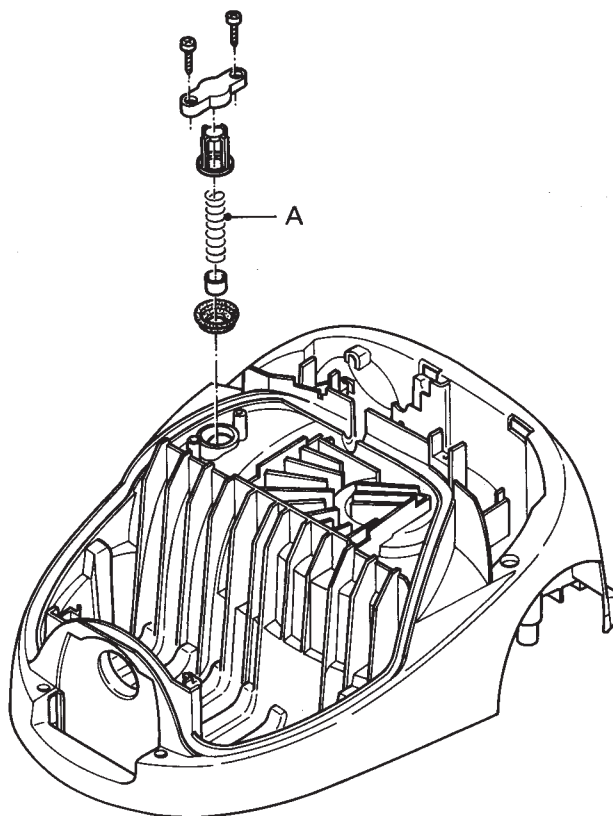

Internal wire tree

The spares available (item 32 and 46) are only suitable for the /A version. The spares for the /B version are not available. The difference between the two versions is the motor connection plug. If item 32 is used for the /B version, the wire tree must be desoldered from the PCB and replaced with the wire tree of the original part (see drawing).

